



NEW **460SX**



INTEGRITY
MOTOR YACHTS

DISCOVER MORE

PART OF THE WHITEHAVEN MOTOR YACHTS FAMILY



WHITEHAVEN
MOTOR YACHTS



DISCOVER MORE

INTRODUCING THE INTEGRITY SX RANGE

Complementing the Classic Integrity Motor Yachts, the new SX range features a slew of exterior styling modifications designed by leading Naval Architect & Designer Misha Merzliakov, to appeal to a new generation of boating families.

While maintaining the key Integrity DNA of spacious entertainer's layouts, undercover cockpit and side walkways for easy access, as well as reliable and economical displacement cruising, the new SX range – comprising 340 SX, 380 SX and 460 SX models – will embody an enhanced elegance, blending the timeless appeal of traditional trawler style attributes with mid-century automotive cues, sophisticated geometry and a variety of materials. The all new Integrity 510 SX is the next step in the development of the range.

Building on the single engine reliability and efficiency all Integrity motor yachts deliver, the SX range will offer electronic engine options.

The new SX Range is a deliberate and successful fusion of the classic lines Integrity is renowned for and contemporary stylistic elements that will be attractive to young families and hip Baby Boomers, adding to their ability to personalize their Integrity.



INTEGRITY
MOTOR YACHTS

DISCOVER MORE

340SEDAN 340SX 380SEDAN 380FB 380SX 380SXF 440SEDAN 440FB 460SX 460SXF 490GRANDSEDAN 510SX 510SXF

Phone 1300 798 735

www.integrityboats.com.au

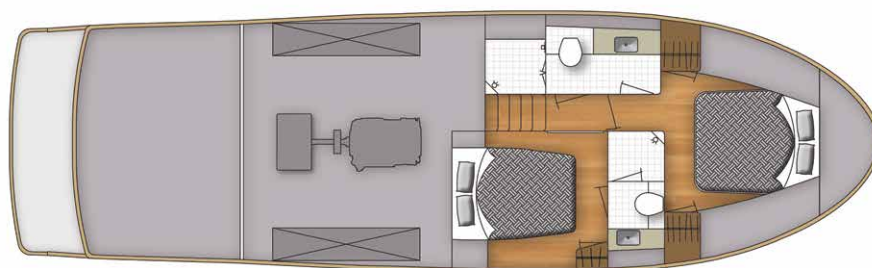
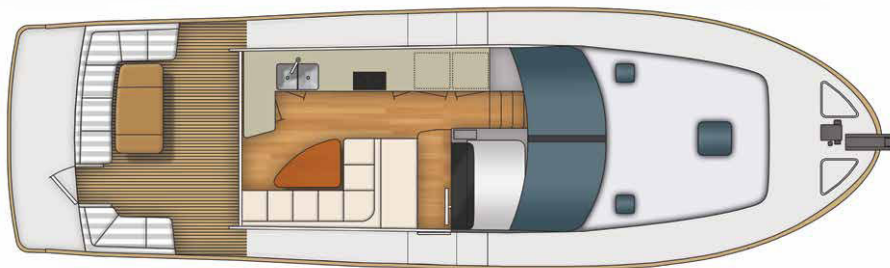

NEW **460SX**

| | |
|-------------------------------------|---|
| Length Overall (inc, swim platform) | 14.06m (46' 2") |
| Beam | 4.23m (13' 8") |
| Maximum Draft approx | 1.3m (4' 2") |
| Sleeping Capacity | 6 person |
| Fuel Capacity approx. | 1,500 litres |
| Water Capacity approx. | 950 litres |
| Holding Tank Capacity approx. | 200 litres |
| Engine | Volvo D6 300HP to inc electronic controls and display |



INTEGRITY
MOTOR YACHTS

DISCOVER MORE

Version: 27/05/20

340SEDAN 340SX 380SEDAN 380FB 380SX 380SXF 440SEDAN 440FB 460SX 460SXF 490GRANDSEDAN 510SX 510SXF

Phone 1300 798 735
www.integrityboats.com.au

460SX

BASE SPECIFICATION

MECHANICAL & ELECTRICAL

Acoustic and thermal insulation throughout engine room
Non-skid flooring in engine room
Freshwater cooling on engine
Engine alarm system
Racor fuel filter
Anti-vibration engine mounts
Fibreglass exhaust system for engine
Fibreglass Aqualift exhaust for generator
Ventilation system includes blowers for engine room
Stainless steel propeller shaft
Dripless PSS shaft seal
Steering stock
Rudder locking pin
Bronze propeller
Bronze Seawater strainers for engine, genset
Bow Thruster 12V 6HP
Stern Thruster 12V 6HP
Full keel, GRP Rudder
All hoses double hose clamped below waterline
Ball valves on all seacocks and skin fittings
Hot water heater 40 Litres
Bilge pumps auto with manual override and high water alarms x 3
Manual bilge pump system
Automatic sump pump fitted to all showers
Fresh water pressure pump high volume 12v
Seawater pump for foredeck 12v
Sanitation system with macerator pump out and deck fitting for dock side pump out
Generator 7kW
Battery charger/inverter 12v 3kva
House Batteries- 400Ahr 12VDC, maintenance free
Engine Batteries -110Ahr 12VDC, Genset Battery 110Ahr 12VDC
All batteries fitted in GRP battery boxes
Battery paralleling system for emergency engine start
LED lighting throughout 12v
Engine room lighting DC
Navigation lights LED international compliant
All AC power outlets RCD protected
Bonding system to hull fittings, zinc anode incl. isolator
Tinned electrical wiring. Where applicable coded and labelled
Electrical panel DC with circuit breakers.

Shore power lead 15Amp

Fusion Stereo

Fusion speakers

SALOON HELM

Twin helm bench seat, including footrest and storage underneath

Console for instruments

Full engine controls

Compass

Anchor winch controls

Safety monitor panel for bilge pumps

Stainless steel steering wheel leather wrapped

VHF radio with aerial

Horn electric

Hydraulic steering

Fuel and Water gauges

Helm sliding door access to side deck

STATEROOM - FORWARD WITH ENSUITE ACCESS

Private access to ensuite/day head

Flooring high quality vinyl

Double berth with foam mattress

Hanging locker

Escape deck hatch from forward cabin stainless steel

Ocean air hatch cover with screen and blind

Reading and overhead lighting LED 12v (DC)

Private entrance door

Storage under berth

Opening porthole stainless steel x 4

STATEROOM - MIDSHIPS WITH PRIVATE ENSUITE

Queen berth with foam mattress

Flooring high quality vinyl

Hanging locker

Opening porthole stainless steel x 2

Reading and overhead lighting LED (DC)

Private door entrance Storage under berth

Mirror Hanging locker with drawers

Private ensuite

Overhead lighting LED 12v (DC)

Opening porthole stainless steel

Solid benchtop surface including basin and single lever faucet

Extraction fan



INTEGRITY
MOTOR YACHTS

DISCOVER MORE

Version: 27/05/20

340SEDAN 340SX 380SEDAN 380FB 380SX 380SXF 440SEDAN 440FB 460SX 460SXF 490GRANDSEDAN 510SX 510SXF

Phone 1300 798 735

www.integrityboats.com.au

460SX

BASE SPECIFICATION

Overhead roof hatch stainless steel

Shower stall with glass door

Shower rose

Mirror

Fresh water flush toilet

Toilet roll holder

Towel hook

CONSTRUCTION

Moulded GRP hull white gelcoat

Hull top sides reinforced for light weight

Independent compartments and stringer system

Solid hand laid fiberglass hull bottom with chines to waterline

Vinyl ester resin used in first two outer layers of hull

Water tight collision bulkhead forward

Water tight light weight cored bulkheads/flooring

White hull colour standard/inc boot stripe

Topsides painted in 2 pack white

DECK

Anchor 45lbs, 60mtrs of chain

Anchor locker accessed by 2 hatches on deck

Anchor safety strap

Bow rail welded stainless (316) flag staff at bow

Bow roller stainless self loading

Cleats stainless steel x 6, (Bow x 2, Spring x 2, and Stern x 2)

Docking lines and fenders x 4

Escape deck hatch from forward cabin stainless steel

Exterior courtesy deck lights

Fuel fillers on side decks

Fwd windscreen in safety glass bonded to FRP frames

Rub Rail with stainless steel insert

Winch 12V with foot switches

Non slip on fwd deck house, side & foredecks & saloon roof

Sliding Side door to FRP house frame

Stainless steel swim ladder

Wash down tap (sea water & fresh) in anchor locker

COCKPIT

Aft seat with teak table

Access hatch lockable

Flood lights, overhead lighting & courtesy DC

Hand held shower hot/cold

Stainless framed main saloon entrance door with hopper window

Teak laid cockpit floor

Wash down tap, fresh water

Cockpit storage under seating

GRP 1200mm swim platform with teak inserts

Shore power inlet located in cockpit locker

DAY HEAD

Private entrance door

Overhead and vanity lighting LED 12v (DC)

Opening porthole stainless steel

Solid benchtop surface including basin and single lever faucet

Extraction fan

Shower stall with glass door

Shower rose

Mirror

Fresh water flush toilet

Toilet roll holder

Towel hook

SALOON & GALLEY

Tinted opening glass saloon windows

Electric hot plate (2 x burner) cover and recessed

Microwave -powered off inverter

Refrigerator and Freezer (DC) underbench

Galley benchtop solid surface, stainless steel twin sink with single lever faucet

Sink and cooktop cover recesses in benchtop

Galley storage cabinets and soft close drawers

Headliner in high quality vinyl

LED lighting overhead 12v

L-Shaped saloon lounge with timber table and storage

Flooring high quality vinyl

Blinds

INTERIOR

High quality vinyl flooring in saloon and companionways and cabins

Vinyl headliner covered ceiling with wood trim design features

Teak Timber satin finish



INTEGRITY
MOTOR YACHTS

DISCOVER MORE

Version: 27/05/20

340SEDAN 340SX 380SEDAN 380FB 380SX 380SXF 440SEDAN 440FB 460SX 460SXF 490GRANDSEDAN 510SX 510SXF

Phone 1300 798 735

www.integrityboats.com.au

460SX

OPTIONS & PRICING

INTEGRITY 460SX STD ENGINE

Volvo D6 300HP to inc electronic controls and display Priced from **\$795,000**

ENGINE OPTIONS AVAILABLE

| | |
|-----------------------------|-------------|
| Nanni N6 285HP | No Charge |
| Nanni N6 325HP | \$5,000.00 |
| Volvo D6 340HP | \$6,000.00 |
| Cummins QSB 6.7 250HP | \$13,995.00 |
| Cummins QSB 6.7 305HP | \$18,500.00 |

OPTIONS AVAILABLE

| | |
|---|----------------------|
| Chain Counter | \$1,020.00 |
| Roof Ladder | \$1,630.00 |
| Electric TV 32" lifter to saloon | \$1,315.00 |
| 12,000btu Air-conditioning lower cabins | \$7,815.00 |
| 16,000btu Air-conditioning to Saloon/Galley..... | \$9,511.00 |
| Gloss Timber Finish | \$4,990.00 |
| Walnut Timber Interior | \$5,960.00 |
| Oak Timber Interior..... | \$2,875.00 |
| Search Light with remote at helm..... | \$1,710.00 |
| Latex mattress upgrade - Single bed | \$1,630.00 |
| Latex mattress upgrade - Queen bed | \$1,937.00 x2 |
| Teak & Holly style high quality vinyl flooring..... | \$4,855.00 |
| Thruster upgrade Bow and Stern to 8HP | \$5,390.00 |
| Additional Waeco fridge underbench in galley | \$3,308.00 |
| Full all weather cockpit covers and clear side doors | \$5,400.00 |
| Breezeway covers to side and from windows in black mesh | \$1,890.00 |
| Waeco 75L fridge in cockpit locker | \$3,260.00 |
| Twin stainless steel rail on swim platform | \$2,993.00 |
| Swim platform centre rail..... | \$1,495.00 |
| Upgrade to twin deluxe helm chairs | \$4,890.00 |

Tender, Solar dual screen Raymarine Package **\$41,417**

This Specification and price is subject to change without notice.

Pricing is in AUD Dollars. Valid until 1/8/2020

RRP \$893 678



INTEGRITY
MOTOR YACHTS

DISCOVER MORE

Version: 27/05/20

340SEDAN 340SX 380SEDAN 380FB 380SX 380SXF 440SEDAN 440FB 460SX 460SXF 490GRANDSEDAN 510SX 510SXF

Phone 1300 798 735

www.integrityboats.com.au

THE INTEGRITY ADVANTAGE

There are a number of things that we believe make our boats leaders in their market. All of these features have been considered, designed and implemented to make your boating experiences more enjoyable. Introducing the integrity advantage.

CLASSIC STYLISH LINES WITH A CONTEMPORARY FEEL

The inspiration for our range comes from the traditional cruising motor yacht, featuring timeless classic lines. We apply contemporary design elements to ensure our range have a striking on water appearance.

PROVEN DISPLACEMENT HULL WITH CLASS LEADING BEAM

With a number of our boats having travelled many thousands of sea miles, the seakeeping abilities of our range is without question. The class leading beam ensures stability in all conditions, particularly when at rest. The displacement hull, greater beam, full length keel and additional weight ensures navigational stability in all seas or when at rest.

MINIMAL HULL SLAP

A little thought about but very important feature, as anyone that has tried to sleep in a boat with water slapping under the hull knows is most annoying. Our boats have no planing strakes meaning no slap at rest.

SOLID HAND LAID FIBREGLASS HULLS FOR STRENGTH AND DURABILITY

Our hulls are laid up to survey standard along with vinyl ester tie layers for strength, durability and osmosis protection. FGI Gelcoat is used on the exterior of the hulls especially applied to suit Australian conditions.

FULL LENGTH KEEL ENCASING THE PROPELLER AND RUDDER

The full length keel assists with stability while offering protection to the propeller and rudder. Should you run aground, simply back off and continue your journey.

EASY TO HANDLE WITH EFFORTLESS DOCKING

Bow and stern thrusters as standard on each model offer finger-tip control ensuring simple and easy berthing in all conditions. The helm door and through rail access makes

single handed step on - step off berthing a breeze. Side rail and stern access from the swim platform means marina and jetty access is safe and simple, no leaps of faith required.

360 DEGREE WIDE WALK AROUND DECK

There is full easy access to all areas of the boat, with wide side decks and high bow, stern and hand rails ensuring safety for passengers and pets at anchor or underway.

LARGE SWIM PLATFORM

The extensive swim platform features a sturdy deep water ladder, plus retractable hot and cold freshwater shower. Stainless stern rails can be added to house BBQ's or preparation boards, tenders and rod holders.

INNOVATIVE COCKPIT DESIGN

The beamy cockpit layout features full wrap around padded seating with a drop down teak table, creating additional accommodation or a day bed along with under-seat storage and self-draining ice box. Combines with the large hopper window and door, spacious saloon and aft galley to create the ultimate entertaining layout. The ice box can also be converted to take a portable 50 or 75 litre Waeco fridge/freezer.

GENERATOR AND REVERSE CYCLE AIR-CONDITIONING

Onan diesel powered generator offered standard allowing for all of your 240V electricity needs including coffee machine, toaster, juicer, hair dryer and more. Ducted air-conditioning is available offering cold and hot air during temperate or cooler climates.

LARGE STAINLESS STEEL HOPPER WINDOW AND DOOR

Critical to creating the flowing cockpit, galley and saloon layout, the sturdy stainless steel hopper window and door is a trademark feature of our range. Each model benefits from this design trademark.



INTEGRITY
MOTOR YACHTS

DISCOVER MORE

340SEDAN 340SX 380SEDAN 380FB 380SX 380SXF 440SEDAN 440FB 460SX 460SXF 490GRANDSEDAN 510SX 510SXF

Phone 1300 798 735

www.integrityboats.com.au

WELL APPOINTED AFT GALLEY

Large fridge, double bowl sink with flick mixer, modern corian style bench tops, microwave and glass twin top hotplate are just the start. Considerable storage is a feature along with additional refrigeration options.

SPACIOUS ACCOMMODATION

Recent design improvements have led to more spacious and roomy accommodation in the bedrooms, featuring full size comfortable island beds. The saloon and cockpit tables lower to create additional double bed accommodation across the range. Cedar lined full length cabinets ensure your clothing is stowed moisture and pest free.

SEPARATE HEAD AND SHOWER COMPARTMENT

Rarely offered in boats of this size, a separate shower ensures little water splash throughout the bathroom and more room to enjoy your shower. Offers privacy for those using the shower or toilet.

RELIABLE FUEL SUPPLY SYSTEM

Racor fuel filters with isolation taps are fitted to bypass blocked filters and reduce the chance of contaminated fuel. Separate ball valves are installed to assist the return or transfer of fuel, and sludge tanks with ball valves for ease of draining are included in the fuel tanks.

LONG RANGE CRUISING WITH LARGE WATER AND FUEL CAPACITY

The long-range performance, economical and mechanical capabilities of our range is supported by considerable fresh water storage and saltwater wash down facilities. Large fuel tanks are also on board, with the option of adding a water maker to extend the cruising capability.

INNOVATIVE ELECTRICAL SYSTEM MANAGEMENT WITH SOLAR

With advancements in solar capabilities and advanced power management systems, your Integrity when fitted with solar can operate for lengthy periods without the need for shore power or generator.

FACTORY BACKED DEALER NETWORK

We maintain Independent Dealers in all major territories, offering full warranty and service support. We appreciate the opportunity to assist our owners with whatever little headaches may arise, and we never let them down.

MORE THAN OWNING A BOAT

Rather than focusing on selling a product, we prefer to introduce our owners to the ultimate lifestyle experience. We offer a series of on-water and off-water events exclusive to those who purchase a boat from our range. Fully escorted trips allow our owners to expand their navigational and boating experiences in the company of other owners and our experienced team members.

INVESTMENT IN A TRUSTED BRAND

Integrity Motor Yachts is the leading displacement motor yacht brand in Australia. With over 100 motor yachts sold and the backing of a dealer network, there's certainty in knowing you're investing in a known and well respected brand with strong resale value.

PRODUCT ENHANCEMENTS

- Rudder locking pin.
- 24 Volt DC system including all pumps etc on vessels 49ft and larger.
- Upgraded bow and stern thrusters on boats 38ft and larger.
- Double hose clamps on all hoses.
- 3000Va Inverter 70 Amp charger system with mains changeover.
- 60 metres of anchor chain.
- Fresh and salt water washdown taps in anchor well.
- All AC outlets RCD protected.
- Shore power inlet now protected in cockpit locker.
- Fusion stereo.
- Stainless steel hatches.



INTEGRITY
MOTOR YACHTS

DISCOVER MORE

340SEDAN 340SX 380SEDAN 380FB 380SX 380SXF 440SEDAN 440FB 460SX 460SXF 490GRANDSEDAN 510SX 510SXF

Phone 1300 798 735
www.integrityboats.com.au