



**NEW** **460SX**



**INTEGRITY**  
**MOTOR YACHTS**

**DISCOVER MORE**

PART OF THE WHITEHAVEN MOTOR YACHTS FAMILY



**WHITEHAVEN**  
MOTOR YACHTS



**DISCOVER MORE**

## INTRODUCING THE INTEGRITY SX RANGE

Complementing the Classic Integrity Motor Yachts, the new SX range features a slew of exterior styling modifications designed by leading Naval Architect & Designer Misha Merzliakov, to appeal to a new generation of boating families.

While maintaining the key Integrity DNA of spacious entertainer's layouts, undercover cockpit and side walkways for easy access, as well as reliable and economical displacement cruising, the new SX range – comprising 340SX, 380SX, 460SX and 510SX models – embody an enhanced elegance, blending the timeless appeal of traditional trawler style attributes with mid-century automotive cues, sophisticated geometry and a variety of materials.

Building on the single engine reliability and efficiency all Integrity motor yachts deliver, the SX range offer large two-piece curved

windcreens with bottom mounted wipers for improved visibility, larger saloon windows designed to match the SX styling and higher ceilings that deliver a more spacious and light filled internal space.

The addition of higher bulwarks to the walk around decks and side access gates for simpler boarding enhances the feeling of comfort and safety. Complimented but subtle upgrades to fixtures and fittings the new SX range delights the senses.

The new SX Range is a deliberate and successful fusion of the classic lines Integrity is renowned for and contemporary stylistic elements that will be attractive to young families and hip Baby Boomers, adding to their ability to personalize their Integrity.



**INTEGRITY**  
MOTOR YACHTS

DISCOVER MORE

340SEDAN 340SX 380SEDAN 380FB 380SX 380SXFB 440SEDAN 440FB 460SX 460SXFB 490GRANDSEDAN 510SX 510SXFB

Phone 1300 798 735

[www.integrityboats.com.au](http://www.integrityboats.com.au)



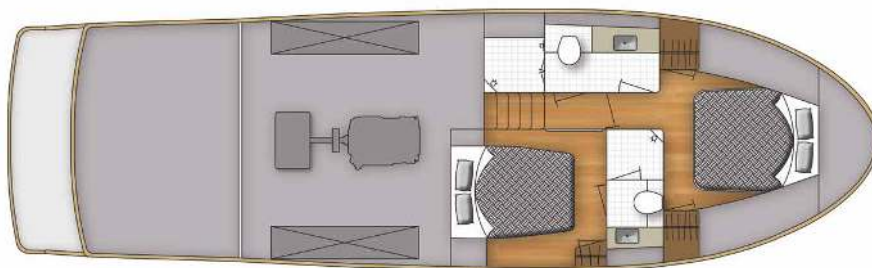
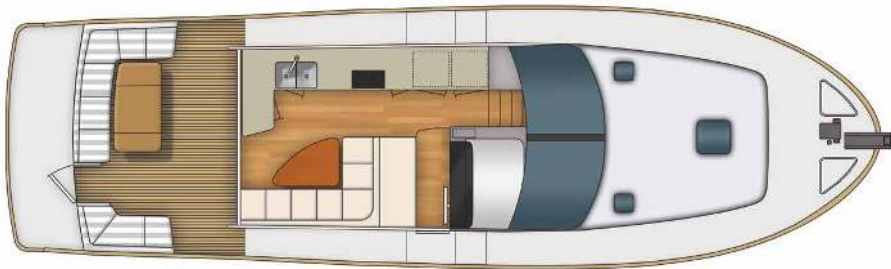

**NEW** **460SX**

Length Overall (inc, swim platform)	14.06m (46' 2")
Beam	4.23m (13' 8")
Maximum Draft approx	1.3m (4' 2")
Sleeping Capacity	6 person
Fuel Capacity approx.	1,500 litres
Water Capacity approx.	950 litres
Holding Tank Capacity approx.	200 litres
Engine	Volvo D6 300HP to inc electronic controls and display



**INTEGRITY**  
MOTOR YACHTS

DISCOVER MORE

Version: 06/11/20

340SEDAN 340SX 380SEDAN 380FB 380SX 380SXF 440SEDAN 440FB 460SX 460SXF 490GRANDSEDAN 510SX 510SXF

Phone 1300 798 735

[www.integrityboats.com.au](http://www.integrityboats.com.au)

# 460SX

## BASE SPECIFICATION

### MECHANICAL & ELECTRICAL

Acoustic and thermal insulation throughout engine room  
Non-skid flooring in engine room  
Freshwater cooling on engine  
Engine alarm system  
Racor fuel filter  
Anti-vibration engine mounts  
Fibreglass exhaust system for engine  
Fibreglass Aqualift exhaust for generator  
Ventilation system includes blowers for engine room  
Stainless steel propeller shaft  
Dripless PSS shaft seal  
Steering stock  
Rudder locking pin  
Bronze propeller  
Bronze Seawater strainers for engine, genset  
Bow Thruster 12V 6HP  
Stern Thruster 12V 6HP  
Full keel, GRP Rudder  
All hoses double hose clamped below waterline  
Ball valves on all seacocks and skin fittings  
Hot water heater 40 Litres  
Bilge pumps auto with manual override and high water alarms x 3  
Manual bilge pump system  
Automatic sump pump fitted to all showers  
Fresh water pressure pump high volume 12v  
Seawater pump for foredeck 12v  
Sanitation system with macerator pump out and deck fitting for dock side pump out  
Generator 7kW  
Battery charger/inverter 12v 3kva  
House Batteries- 400Ahr 12VDC, maintenance free  
Engine Batteries -110Ahr 12VDC, Genset Battery 110Ahr 12VDC  
All batteries fitted in GRP battery boxes  
Battery paralleling system for emergency engine start  
LED lighting throughout 12v  
Engine room lighting DC  
Navigation lights LED international compliant  
All AC power outlets RCD protected  
Bonding system to hull fittings, zinc anode incl. isolator  
Tinned electrical wiring. Where applicable coded and labelled  
Electrical panel DC with circuit breakers.

Shore power lead 15Amp

Fusion Stereo

Fusion speakers

### SALOON HELM

Twin helm bench seat, including footrest and storage underneath

Console for instruments

Full engine controls

Compass

Anchor winch controls

Safety monitor panel for bilge pumps

Stainless steel steering wheel leather wrapped

VHF radio with aerial

Horn electric

Hydraulic steering

Fuel and Water gauges

Helm sliding door access to side deck

### STATEROOM - FORWARD WITH ENSUITE ACCESS

Private access to ensuite/day head

Flooring high quality vinyl

Double berth with foam mattress

Hanging locker

Escape deck hatch from forward cabin stainless steel

Ocean air hatch cover with screen and blind

Reading and overhead lighting LED 12v (DC)

Private entrance door

Storage under berth

Opening porthole stainless steel x 4

### STATEROOM - MIDSHIPS WITH PRIVATE ENSUITE

Queen berth with foam mattress

Flooring high quality vinyl

Hanging locker

Opening porthole stainless steel x 2

Reading and overhead lighting LED (DC)

Private door entrance Storage under berth

Mirror Hanging locker with drawers

Private ensuite

Overhead lighting LED 12v (DC)

Opening porthole stainless steel

Solid benchtop surface including basin and single lever faucet

Extraction fan



**INTEGRITY**  
MOTOR YACHTS

DISCOVER MORE

Version: 06/11/20

340SEDAN 340SX 380SEDAN 380FB 380SX 380SXF 440SEDAN 440FB 460SX 460SXF 490GRANDSEDAN 510SX 510SXF

Phone 1300 798 735

[www.integrityboats.com.au](http://www.integrityboats.com.au)

# 460SX

## BASE SPECIFICATION

Overhead roof hatch stainless steel

Shower stall with glass door

Shower rose

Mirror

Fresh water flush toilet

Toilet roll holder

Towel hook

### CONSTRUCTION

Moulded GRP hull white gelcoat

Hull top sides reinforced for light weight

Independent compartments and stringer system

Solid hand laid fiberglass hull bottom with chines to waterline

Vinyl ester resin used in first two outer layers of hull

Water tight collision bulkhead forward

Water tight light weight cored bulkheads/flooring

White hull colour standard/inc boot stripe

Topsides painted in 2 pack white

### DECK

Anchor 45lbs, 60mtrs of chain

Anchor locker accessed by 2 hatches on deck

Anchor safety strap

Bow rail welded stainless (316) flag staff at bow

Bow roller stainless self loading

Cleats stainless steel x 6, (Bow x 2, Spring x 2, and Stern x 2)

Docking lines and fenders x 4

Escape deck hatch from forward cabin stainless steel

Exterior courtesy deck lights

Fuel fillers on side decks

Fwd windscreen in safety glass bonded to FRP frames

Rub Rail with stainless steel insert

Winch 12V with foot switches

Non slip on fwd deck house, side & foredecks & saloon roof

Sliding Side door to FRP house frame

Stainless steel swim ladder

Wash down tap (sea water & fresh) in anchor locker

### COCKPIT

Aft seat with teak table

Access hatch lockable

Flood lights, overhead lighting & courtesy DC

Hand held shower hot/cold

Stainless framed main saloon entrance door with hopper window

Teak laid cockpit floor

Wash down tap, fresh water

Cockpit storage under seating

GRP 1200mm swim platform with teak inserts

Shore power inlet located in cockpit locker

### DAY HEAD

Private entrance door

Overhead and vanity lighting LED 12v (DC)

Opening porthole stainless steel

Solid benchtop surface including basin and single lever faucet

Extraction fan

Shower stall with glass door

Shower rose

Mirror

Fresh water flush toilet

Toilet roll holder

Towel hook

### SALOON & GALLEY

Tinted opening glass saloon windows

Electric hot plate (2 x burner) cover and recessed

Microwave -powered off inverter

Refrigerator and Freezer (DC) underbench

Galley benchtop solid surface, stainless steel twin sink with single lever faucet

Sink and cooktop cover recesses in benchtop

Galley storage cabinets and soft close drawers

Headliner in high quality vinyl

LED lighting overhead 12v

L-Shaped saloon lounge with timber table and storage

Flooring high quality vinyl

Blinds

### INTERIOR

High quality vinyl flooring in saloon and companionways and cabins

Vinyl headliner covered ceiling with wood trim design features

Teak Timber satin finish



**INTEGRITY**  
MOTOR YACHTS

DISCOVER MORE

Version: 06/11/20

340SEDAN 340SX 380SEDAN 380FB 380SX 380SXF 440SEDAN 440FB 460SX 460SXF 490GRANDSEDAN 510SX 510SXF

Phone 1300 798 735

[www.integrityboats.com.au](http://www.integrityboats.com.au)

# THE INTEGRITY ADVANTAGE

There are a number of things that we believe make our boats leaders in their market. All of these features have been considered, designed and implemented to make your boating experiences more enjoyable. Introducing the integrity advantage.

## **CLASSIC STYLISH LINES WITH A CONTEMPORARY FEEL**

The inspiration for our range comes from the traditional cruising motor yacht, featuring timeless classic lines. We apply contemporary design elements to ensure our range have a striking on water appearance.

## **PROVEN DISPLACEMENT HULL WITH CLASS LEADING BEAM**

With a number of our boats having travelled many thousands of sea miles, the seakeeping abilities of our range is without question. The class leading beam ensures stability in all conditions, particularly when at rest. The displacement hull, greater beam, full length keel and additional weight ensures navigational stability in all seas or when at rest.

## **MINIMAL HULL SLAP**

A little thought about but very important feature, as anyone that has tried to sleep in a boat with water slapping under the hull knows is most annoying. Our boats have no planing strakes meaning no slap at rest.

## **SOLID HAND LAID FIBREGLASS HULLS FOR STRENGTH AND DURABILITY**

Our hulls are laid up to survey standard along with vinyl ester tie layers for strength, durability and osmosis protection. FGI Gelcoat is used on the exterior of the hulls especially applied to suit Australian conditions.

## **FULL LENGTH KEEL ENCASING THE PROPELLER AND RUDDER**

The full length keel assists with stability while offering protection to the propeller and rudder. Should you run aground, simply back off and continue your journey.

## **EASY TO HANDLE WITH EFFORTLESS DOCKING**

Bow and stern thrusters as standard on each model offer finger-tip control ensuring simple and easy berthing in all conditions. The helm door and through rail access makes

single handed step on - step off berthing a breeze. Side rail and stern access from the swim platform means marina and jetty access is safe and simple, no leaps of faith required.

## **360 DEGREE WIDE WALK AROUND DECK**

There is full easy access to all areas of the boat, with wide side decks and high bow, stern and hand rails ensuring safety for passengers and pets at anchor or underway.

## **LARGE SWIM PLATFORM**

The extensive swim platform features a sturdy deep water ladder, plus retractable hot and cold freshwater shower. Stainless stern rails can be added to house BBQ's or preparation boards, tenders and rod holders.

## **INNOVATIVE COCKPIT DESIGN**

The beamy cockpit layout features full wrap around padded seating with a drop down teak table, creating additional accommodation or a day bed along with under-seat storage and self-draining ice box. Combines with the large hopper window and door, spacious saloon and aft galley to create the ultimate entertaining layout. The ice box can also be converted to take a portable 50 or 75 litre Waeco fridge/freezer.

## **GENERATOR AND REVERSE CYCLE AIR-CONDITIONING**

Onan diesel powered generator offered standard allowing for all of your 240V electricity needs including coffee machine, toaster, juicer, hair dryer and more. Ducted air-conditioning is available offering cold and hot air during temperate or cooler climates.

## **LARGE STAINLESS STEEL HOPPER WINDOW AND DOOR**

Critical to creating the flowing cockpit, galley and saloon layout, the sturdy stainless steel hopper window and door is a trademark feature of our range. Each model benefits from this design trademark.



**INTEGRITY**  
MOTOR YACHTS

**DISCOVER MORE**

**340SEDAN 340SX 380SEDAN 380FB 380SX 380SXF 440SEDAN 440FB 460SX 460SXF 490GRANDSEDAN 510SX 510SXF**

Phone 1300 798 735

[www.integrityboats.com.au](http://www.integrityboats.com.au)

## WELL APPOINTED AFT GALLEY

---

Large fridge, double bowl sink with flick mixer, modern corian style bench tops, microwave and glass twin top hotplate are just the start. Considerable storage is a feature along with additional refrigeration options.

## SPACIOUS ACCOMMODATION

---

Recent design improvements have led to more spacious and roomy accommodation in the bedrooms, featuring full size comfortable island beds. The saloon and cockpit tables lower to create additional double bed accommodation across the range. Cedar lined full length cabinets ensure your clothing is stowed moisture and pest free.

## SEPARATE HEAD AND SHOWER COMPARTMENT

---

Rarely offered in boats of this size, a separate shower ensures little water splash throughout the bathroom and more room to enjoy your shower. Offers privacy for those using the shower or toilet.

## RELIABLE FUEL SUPPLY SYSTEM

---

Racor fuel filters with isolation taps are fitted to bypass blocked filters and reduce the chance of contaminated fuel. Separate ball valves are installed to assist the return or transfer of fuel, and sludge tanks with ball valves for ease of draining are included in the fuel tanks.

## LONG RANGE CRUISING WITH LARGE WATER AND FUEL CAPACITY

---

The long-range performance, economical and mechanical capabilities of our range is supported by considerable fresh water storage and saltwater wash down facilities. Large fuel tanks are also on board, with the option of adding a water maker to extend the cruising capability.

## INNOVATIVE ELECTRICAL SYSTEM MANAGEMENT WITH SOLAR

---

With advancements in solar capabilities and advanced power management systems, your Integrity when fitted with solar can operate for lengthy periods without the need for shore power or generator.

## FACTORY BACKED DEALER NETWORK

---

We maintain Independent Dealers in all major territories, offering full warranty and service support. We appreciate the opportunity to assist our owners with whatever little headaches may arise, and we never let them down.

## MORE THAN OWNING A BOAT

---

Rather than focusing on selling a product, we prefer to introduce our owners to the ultimate lifestyle experience. We offer a series of on-water and off-water events exclusive to those who purchase a boat from our range. Fully escorted trips allow our owners to expand their navigational and boating experiences in the company of other owners and our experienced team members.

## INVESTMENT IN A TRUSTED BRAND

---

Integrity Motor Yachts is the leading displacement motor yacht brand in Australia. With over 100 motor yachts sold and the backing of a dealer network, there's certainty in knowing you're investing in a known and well respected brand with strong resale value.

## PRODUCT ENHANCEMENTS

---

- Rudder locking pin.
- 24 Volt DC system including all pumps etc on vessels 49ft and larger.
- Upgraded bow and stern thrusters on boats 38ft and larger.
- Double hose clamps on all hoses.
- 3000Va Inverter 70 Amp charger system with mains changeover.
- 60 metres of anchor chain.
- Fresh and salt water washdown taps in anchor well.
- All AC outlets RCD protected.
- Shore power inlet now protected in cockpit locker.
- Fusion stereo.
- Stainless steel hatches.



**INTEGRITY**  
MOTOR YACHTS

DISCOVER MORE

340SEDAN 340SX 380SEDAN 380FB 380SX 380SXF 440SEDAN 440FB 460SX 460SXF 490GRANDSEDAN 510SX 510SXF

Phone 1300 798 735  
[www.integrityboats.com.au](http://www.integrityboats.com.au)



## Integrity 460SX Yachtshare

### Standard Options.

- 1 Base Boat Integrity 460SX

### Factory Options (Options from Spec Sheet)

- 2 Chain Counter
- 3 Roof Ladder
- 4 Electric TV Lifter to Saloon
- 5 12000BTU Air-conditioning to lower cabins
- 6 16000BTU Air- Conditioning to Saloon/Galley
- 10 Search Light with remote at helm
- 12 Latex mattress upgrade- Queen bed x2
- 13 Nautikflor Teak & Holley style vinyl flooring
- 14 Thruster upgrade Bow and Stern(8hp)
- 15 Additional Waeco fridge underbench to galley
- 16 Full weather cockpit covers and clear side windows
- 17 Breezeway covers to side and front windows in black mesh
- 18 Waeco 75L fridge in cockpit locker
- 21 Upgrade to twin deluxe helm chair

### Dealer Custom Options

- Simrad Navigation Package(Autopilot, NSS16 EVO 3S)
  - Sony 7000G 43" Smart TV
  - Sony Blu-Ray
  - Set of Bedding for both Cabins
  - Monogram Towels
  - Aqualuma UW lighting
  - Semex deck sealant
  - Deck Cushion
  - Winch pole
  - Swift marine
-